

387, Pt. 4, Sec. 2.
 1st

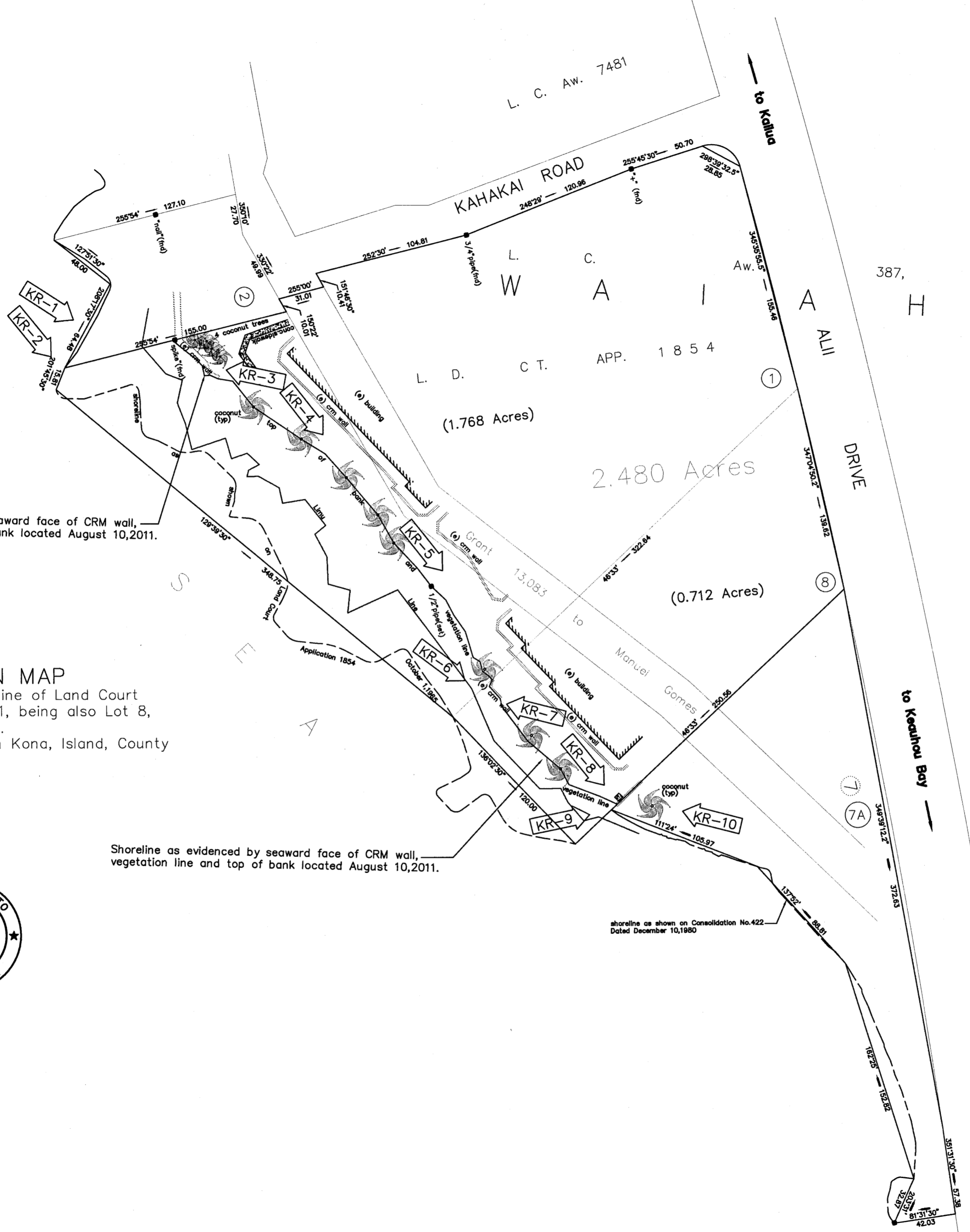

Shoreline as evidenced by seaward face of CRM wall, vegetation line and top of bank located August 10, 2011.

Shoreline as evidenced by seaward face of CRM wall, vegetation line and top of bank located August 10, 2011.

shoreline as shown on Consolidation No. 422 Dated December 10, 1880

SHORELINE LOCATION MAP

Being a location of the shoreline of Land Court Application 1854, Map 1, Lot 1, being also Lot 8, L.C. Award 387, Pt. 4, Sec. 2. Situated at Waiaha 1st., North Kona, Island, County and State of Hawaii. TMK (3) 7-5-18:071 August 10, 2011

Owner:
 Guy A. Paul, Trustee
 75-5888 Allii Drive
 Kailua-Kona, Hawaii 96740

This work was prepared by me or under my direct supervision

Blaine W. Ito
 Licensed Professional Surveyor
 Certificate Number 5691

Drawn By:
 True North Surveys, Inc.
 P.O. Box 421
 Paaulo, Hawaii 96776



TRUE NORTH
 Scale: 1 in. = 50 ft.