

Section B.B. Through Entry Sign & Landscaping

Scale: 1/8"=1'-0"

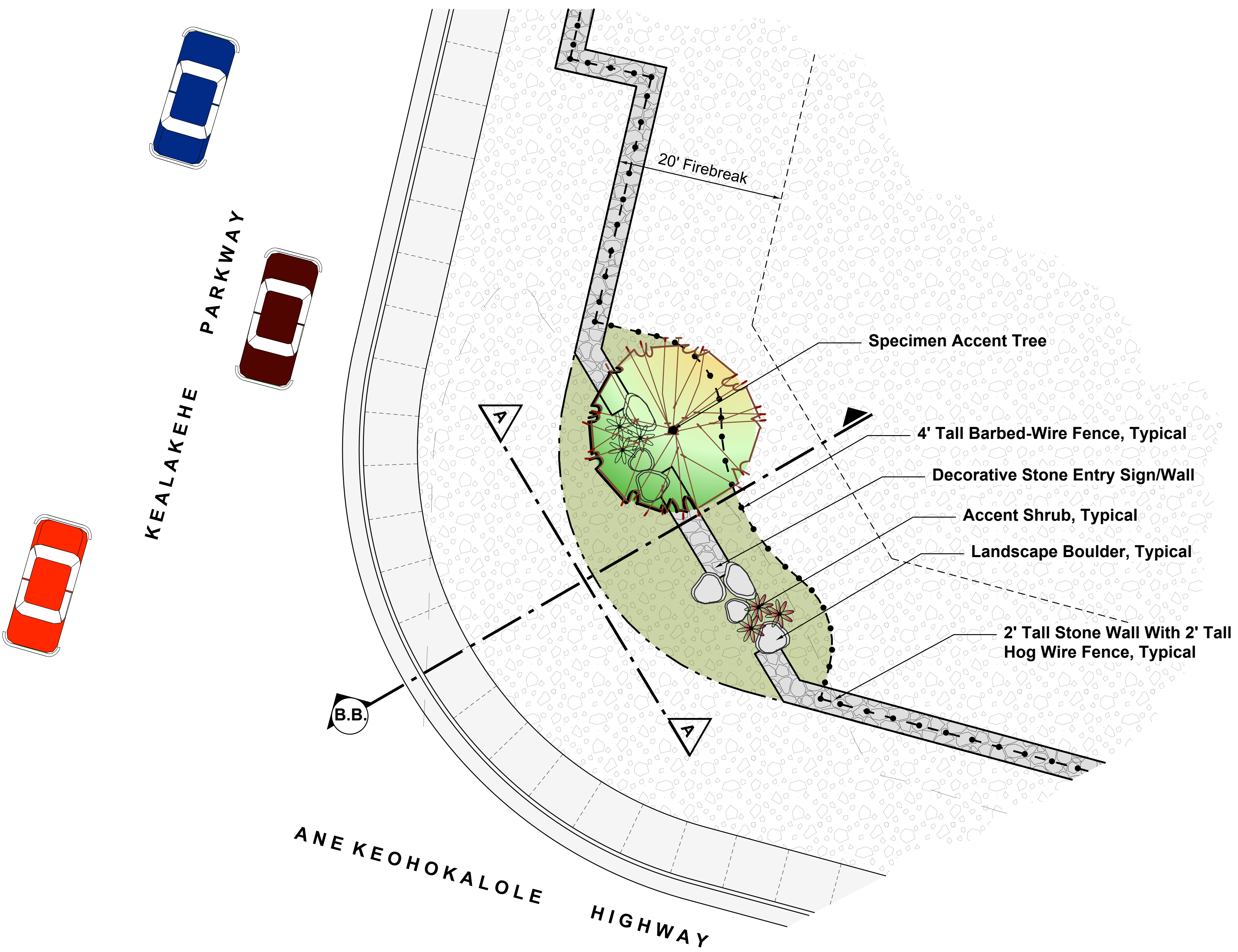

AUPAKA PRESERVE - Plan Enlargement @ Entry Sign

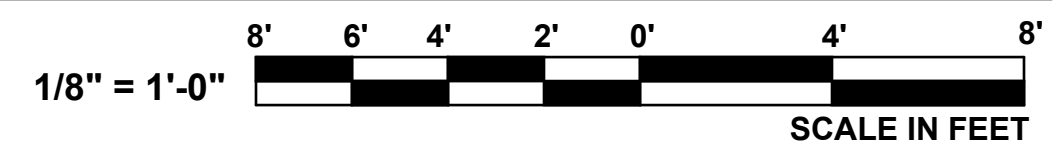
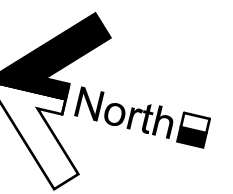

Kolomona
(*Senna gaudichaudii* (Hook and Arnott) H. Irwin and Barneby)
Status: Indigenous
Traditional Use: None Known



Ko'oko'olau
(*Bidens micrantha* ssp. *ctenophylla* (Sherff) Nagata & Ganders)
Status: Endemic, Species of Concern
Traditional Use: Herbal Tea; General Tonic; Treat Throat and Stomach Aches



Maiapilo
(*Capparis sandwichiana* DC)
Status: Endemic, Species of Concern
Traditional use: None Known



Mamane
(*Sophora chrysophylla* (Salisb.) Seem)
Status: Endemic
Traditional Use: Construction; Thatching
Poles: Spears

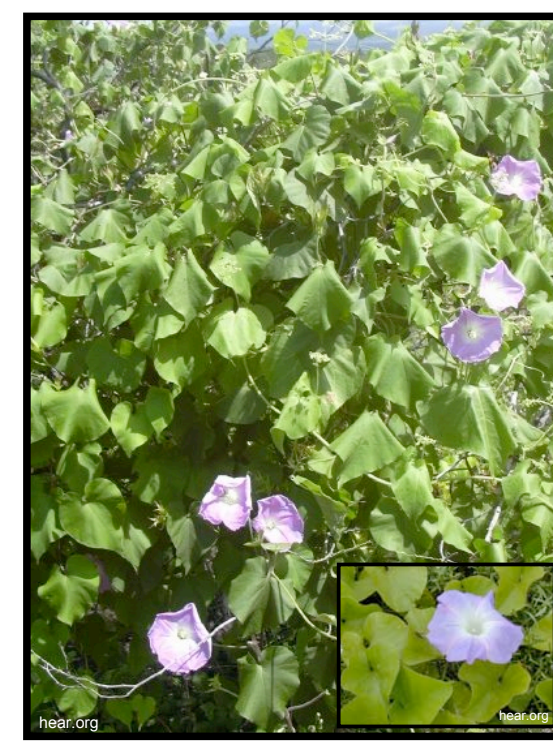

Morning Glory
(*Ipomoea indica* (J. Burm.) Merr.)
Status: Indigenous
Traditional Use: Purge; Treat Broken Bones



Naio
(*Myoporum sandwicense* A. Gray)
Status: Indigenous
Traditional Use: Hale Posts; Thatching Poles



Ohe Makai
(*Reynoldsia sandwicensis* A. Gray)
Status: Endemic, Species of Concern
Traditional Use: Stills



Uhaloa
(*Waltheria indica* L.)
Status: Indigenous
Traditional Use: None Known



Uhiuhi
(*Caesalpinia kavaensis* H. Mann)
Status: Endemic, Endangered
Traditional Use: Farming Tools; Hale Posts; Leis



Wiliwili
(*Erythrina sandwicensis* Degener)
Status: Endemic
Traditional Use: Ingredient in Paint; Leis; Outrigger Construction; Surfboards

If you're interested in learning more about this project or the possibility of getting involved in the restoration planned for the Preserves, please contact Leonard Bisel Associates at:

Phone Number: (808) 969-9533
E-mail: lbisel@hawaii.rr.com